



## **Denman Marine Newsletter - May 2018**

Hi there, and welcome to the latest Denman Marine newsletter.

In this month's newsletter we have;

- Sassafras Canoe Spotlight
- May Special - Free paddle with Sassafras full kit
- Customer Build Update
- New Website Launched
- Barton Marine - ClamSeal

If there is anything you would like to see in our future newsletters, discuss, query or order, please contact us via the [contact form](#) on our [Denman Marine website](#).

## Sassafras Canoes



[Sassafras Canoe](#)

Today we think of wooden canoes as being strip-built in cedar. But lapstrake canoes have an even longer history. The legendary Rushton lapstrake canoes are considered the pinnacle of the canoe builder's art. But that style of construction is very, very complex, beyond even intermediate builders.

Chesapeake Light Craft first introduced the lapstrake Sassafras canoes in the late 1990's. Named after a placid and scenic river on the upper Chesapeake, these handsome canoes are at home in rivers, lakes, and bays, able enough to surmount wind chop and powerboat wakes, and to carry a good load.

Simpler strip building, and later aluminum and fiberglass, took over. Now, CLC's revolutionary [LapStitch™](#) building method allows lapstrake canoes to be built by someone with no previous woodworking experience. All the planks and other parts are pre-cut. No strongback, molds, frames, or steam bending are required; building a LapStitch™ canoe is basically a matter of gluing all the pre-cut parts together.



## Sassafras 12

The [Sassafras 12](#) canoe is so light that you can put it on your shoulder and stroll casually down a wooded trail to a hidden lake or stream, fishing rod and tackle box in the other. That was the idea behind the original "trapper" or "pack" canoes. CLC's 28-pound Sassafras 12 carries on the tradition - but with modern building methods.

Though she can be carried, or paddled, by a child, she'll hold a 250-pound load. She tracks well, turns easily, and is stable enough for fishing. For maximum efficiency you'll want to paddle the Sassafras 12 with a double (kayak) paddle.



## Sassafras 16

Like many traditional canoes, the [Sassafras 16](#) is symmetrical, bow and stern. This allows a solo paddler to sit facing "backwards" on the forward seat for better trim. Her slightly rounded hull offers more speed and responsiveness than many of the plastic or 'glass boats you may have paddled. Her hull is slightly rockered - not for maneuvering in whitewater, but rather to reduce wetted surface area - making her almost effortless to paddle. She has a smooth or "well dampened" feel that is characteristic of good wooden canoes.

Purchase a [Sassafras 12 or 16](#) during May 2018 and receive a free kayak paddle or pair of canoe paddles. See our May Special for further information. Otherwise please place an order via our [website](#) or [contact us](#) if you would like further information.



## New Website Launched



After many months of work, we successfully launched our new website in early April. Visually the site is very similar to our old one, however, we now have an e-commerce platform included so you can purchase most of our products online including the fantastic range of [Chesapeake Light Craft kits](#). The CLC kit range includes [kayaks](#), [paddleboards](#), [campers](#), [rowing](#) and [sailing](#) boats that are easily built at home.

As with any website upgrade, there may be something that we have missed so if you see any errors please let us know here or via our [contact form](#).

Please note, shipping on larger items such as kits is not calculated automatically as freight charges are tailored to suit individual orders (unless otherwise specified). Once you have placed an order , we will contact you with a separate shipping invoice. Most smaller items such as plans and manual packages will have shipping included in their price.

You can find information on shipping as well as estimates [here](#), and information on our payment methods [here](#).

# MAY SPECIAL

**Free Canoe or Kayak paddle with  
Sassafras full kit**



All [Sassafras 12 and 16](#) full kit orders during the month of May 2018 will receive a free kayak paddle (recommended for Sassafras 12) or pair of canoe paddles. [Contact us](#) and place your order for a [Sassafras 12](#) or [Sassafras 16](#) today to take advantage of this offer while it lasts.

\*Offer valid from 01/05/2018 till 31/05/2018. Applies to Sassafras 12 and 16 full kit purchases only. Not applicable to wood only kits, or plans and manual packages. Paddles may differ from image.



## Customer build update

Below we have some pictures that you have sent in during various stages of kit construction. We are always thrilled to see your project during any phase of construction, so please [send us](#) in your pictures so that we may publish them in future newsletters for everyone to enjoy.



Andy's [Matunuck Surf Kayak](#)



Tom's Mill Creek 16.5



Tom's Mill Creek 16.5





Scott's Wood Duck Double

**Barton**  
**MARINE**  
*control the power*



Pat pending G80329522.7

## ClamSeal

The [ClamSeal](#)™ can instantly repair splits and tears up to 90mm (3 ½ ") in length without the use of any hand tools, or adhesive.

[ClamSeal](#)™ is a patented glue-less repair system and instantly repairs small tears or splits in inflatables above or below the waterline - regardless of the fact that the material may be wet.

The system works by using two half "shells" that screw together tightly, using the inflatable material itself as a water and air-tight seal. It is quick and easy to fit and effects an immediate repair which can keep you afloat until a more permanent repair can be made.

- Quick and easy to fit
- Requires no adhesive or tape
- Can be used above or below the waterline
- Can be used on wet materials
- Provides an instant repair
- Re-usable again and again.

Denman Marine can supply anything from Barton Marine's wide range of products including their [ClamSeal](#)™. See [here](#) to view their range, otherwise please [contact us](#) to discuss your requirements.



Open the ClamSeal™ and insert the base plate into the split.



Pull the plates of the ClamSeal™ together, across the split, using the lanyard.



With the 2 plates pulled together, simply hand-tighten the nut for a Clam-tight seal!

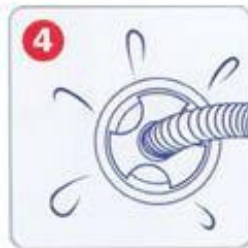

Reinflate and your safe to continue on your way!

## Contact us

Please feel free to contact us at any time via our [contact form](#) to discuss your next boat or project.

You can find a link to our current a previous newsletters [here](#).

Please note, all prices listed above are in Australian Dollars and include GST.



Denman Marine Pty Ltd ATF | ABN: 54779786053  
2888 Channel Highway Kettering

Tasmania 7155

<http://www.denmanmarine.com.au/>

Like

Tweet

Share

Forward